



# SINGLE-USE PRODUCTS



AFFORDABLE  
INNOVATIONS

**RUMEX** best-selling instruments are now available in a single-use edition.

The doctors around the world choose to perform the surgeries using the single-use instruments because they are:

**SAFE.** Instruments are supplied sterile in a protective case and ready for use;

**DURABLE.** High-quality stainless steel and heat-resistant plastics are used in production;

**COST-EFFECTIVE.** No additional expenses on sterilizing equipment, repairs and storage space needed; considerably reduced price due to the composition of materials.

The range of RUMEX single-use instruments is designed to assist the surgeons in various procedures on both anterior and posterior segments of the eye. The most commonly used items are available from stock.

**SAFE. DURABLE. COST-EFFECTIVE.**



# CONTENTS

<b>DISPOSABLE PHACO PACK</b>	<b>4</b>
<b>IOLs</b>	<b>6</b>
HYDROPHOBIC	6
HYDROPHILIC	7
<b>DISPOSABLE IOL INJECTOR</b>	<b>7</b>
<b>OVDs</b>	<b>8</b>
DISPERSIVE	8
COHESIVE	9
<b>DISPOSABLE KNIVES</b>	<b>10</b>
<b>DISPOSABLE INSTRUMENTS FOR ANTERIOR SEGMENT</b>	<b>12</b>
SPECULUMS	12
IRIS RETRACTORS	12
SCISSORS	12
FORCEPS	13
MANIPULATORS	14
<b>DISPOSABLE INSTRUMENTS FOR POSTERIOR SEGMENT</b>	<b>15</b>
FORCEPS	15
SCISSORS	15
<b>SILICONE OIL</b>	<b>16</b>
SILICONE OIL INFUSION SYSTEMS	16
<b>DISPOSABLE TROCAR SYSTEM</b>	<b>17</b>
<b>DISPOSABLE BACKFLUSH HANDLES</b>	<b>18</b>
<b>DISPOSABLE CANNULAS</b>	<b>19</b>

# DISPOSABLE PHACO PACK

Specially designed to perform a phacoemulsification procedure, DISPOSABLE PHACO PACK is a safe, convenient and cost-effective solution. Complete your set with any 6 or more different items from the list of the most popular RUMEX products for cataract surgery and get special discount!





# DISPOSABLE PHACO PACK

PHACO  
PACK

## Choose your PHACO PACK content from the list of items below:

### IOLs\*

**Hydro-Sense Aspheric Hydrophilic IOL** for 2.20 mm incision  
**Hydro-Sense Aspheric Yellow Hydrophilic IOL** for 2.20 mm incision  
**AquaFree Yellow Aspheric Hydrophobic IOL** for 2.20 mm incision

### IOL Injector\*

Viscoject™ Eco Injector Set **VE2200** for 2.20 mm incision

### OVDs\*

**Supreme.** Dispersive Viscoelastic Solution set for intraocular use, HPMC 2%  
**SmartVisc.** Cohesive Viscoelastic Solution set for intraocular use, Sodium Hyaluronate 1.6%  
**SmartVisc PLUS.** Cohesive Viscoelastic Solution set for intraocular use, Sodium Hyaluronate 3%

### Disposable Knives

**SL-22** Slit Knife for 1.80 mm incision  
**CC-22** Clear Corneal Knife for 2.20 mm incision  
**SP-15** Side Port Knife for 1.00 mm incision

### Disposable Forceps

**4-0331D** Utrata Capsulorhexis Forceps

### Disposable Manipulators

**7-063D** Nagahara Phaco Chopper, RHD  
**5-032D** Sinskey Hook

### Disposable Speculum

**14-022D** Barraquer Speculum With Solid Blades

IOLs

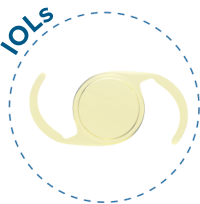

OVDs



Forceps

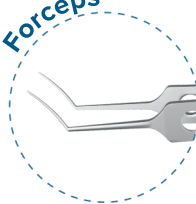

Manipulators



\*Not available in the US

Product design and/or features that do not influence its functionality and main parameters are subject to change.

## HYDROPHOBIC IOLs

### AquaFree Yellow Aspheric Hydrophobic\*

**MOST  
POPULAR**

PHACO  
PACK

Min. incision size	2.20 mm
Power range	0 .. +30 D
Overall diameter	13 mm
Optic diameter	6.0 mm
Self-unfolding	Yes
Water content	< 0.50%
Angulation	0°
Material	Natural Yellow Hydrophobic Acrylic
Refractive index	1.50
A-constant	118.7
UV Filter	Yes
Shelf Life	5 years



### Aqua-Free Yellow Aspheric Preloaded\*

Aqua Free Yellow Aspheric Hydrophobic IOL is available in preloaded Accuject™ injection system with the syringe injector type which allows to perform implantation for less than 5 seconds.

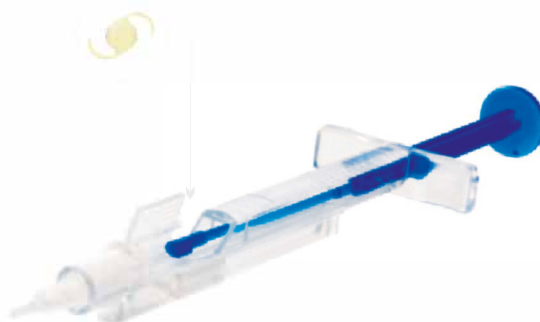

### Advantages

- Increased contrast sensitivity
- Easy to inject, excellent folding and unfolding ability
- Not tacky – lens does not stick to itself or instruments
- No spherical aberrations





Minimized glare and unwanted images

\*Not available in the US

Product design and/or features that do not influence its functionality and main parameters are subject to change.

## HYDROPHILIC IOLs

<b>MOST POPULAR</b>	<b>Hydro-Sense Aspheric*</b> <b>PHACO PACK</b>		<b>Hydro-4 Aspheric*</b>		<b>Hydro-Sense Aspheric Yellow*</b> <b>PHACO PACK</b>	
Min. incision size	2.20 mm		<b>1.80 mm</b>		2.20 mm	
Power range	-5 .. +38 D		-5 .. +38 D		-5 .. +38 D	
Overall diameter	12.5 mm		11 mm		12.5 mm	
Optic diameter	6.0 mm		6.0 mm		6.0 mm	
Self unfolding	Yes		Yes		Yes	
Water content	23.5 – 27.5 %		23.5 – 27.5 %		23.5 – 27.5 %	
Angulation	5°		5°		5°	
Material	Hydrophilic Acrylic		Hydrophilic Acrylic		<b>Natural Yellow</b> Hydrophilic Acrylic	
Refractive index	1.46		1.46		1.46	
A-constant	118		118		118	
UV Filter	Yes		Yes		Yes	
Shelf Life	5 years		5 years		5 years	



## DISPOSABLE IOL INJECTOR

Viscojet™ Eco is an injection system with unbeatable quality and performance in its price segment.

Single-use Viscojet™ Eco  
IOL injection system  
VE2200\*



PHACO  
PACK

20  
PER  
BOX

- For hydrophilic and hydrophobic 1-piece lenses
- Complete control of every step of lens injection
- Soft-tip technology

\*Not available in the US

Product design and/or features that do not influence its functionality and main parameters are subject to change.

DISPERSIVE OVDs

**MOST  
POPULAR**



**SUPREME\***  
**Ophthalmic Viscosurgical Device**

Supreme is a dispersive viscoelastic solution of low molecular weight, highly purified grade of hydroxypropyl methylcellulose (HPMC) 2%, clear, isotonic, sterile, non-inflammatory and non-pyrogenic in nature. It is used for intraocular injection during anterior segment surgery.

**Physico-chemical properties**

Type	Dispersive
Material	2% HPMC
Molecular weight	86 000 Da
Viscosity	3 000–4 000 cSt
pH	6.0–7.8
Osmolality	250–350 mOsmol/kg
Volume	2 ml
Shelf Life	3 years

**Advantages**

- highly dispersive
- the best endothelial protection
- easy removal
- completely transparent
- no refrigeration necessary
- easy transportation and storage (2–35 °C)

**Dispersive Solution**

**Supreme** is used to:

- coat ocular structures during cataract surgery: in the initial part, during capsulorhexis and phacoemulsification, and during ultrasound
- protect corneal endothelium in an eye where endothelium pathology is suspected

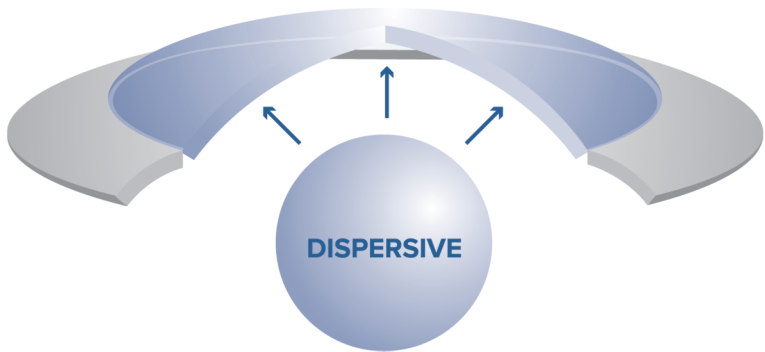

\*Not available in the US

Product design and/or features that do not influence its functionality and main parameters are subject to change.

COHESIVE OVDs

MOST  
POPULAR



SMARTVISC / SMARTVISC PLUS\*  
Ophthalmic Viscosurgical Device

SmartVisc and SmartVisc Plus are cohesive viscoelastic solutions of high molecular weight used for intraocular injection during anterior segment surgery of the eye.

Physico-chemical properties

	SmartVisc	SmartVisc PLUS
	Sodium Hyaluronate 1.6 %	Sodium Hyaluronate 3.0 %
Molecular Weight	1.2–2.0 m Da	1.0–1.8 m Da
Viscosity	approx. 80 000 mPas	approx. 400 000 mPas
Osmolality		270–400 mOsmol/kg
Storage		2–25°C
pH		6.8–7.4
Volume		1.00 ml
Shelf Life		3.5 years

Advantages

- no refrigeration necessary
- good maintenance of the anterior chamber and the capsular bag
- controlled capsulorhexis
- easy implantation
- better adhesiveness on the corneal endothelium during phacoemulsification
- favorable environment to ophthalmic surgery
- excellent protection against mechanical damages
- steam sterilized

Cohesive Solution

- SmartVisc is used to:
- maintain space and pressure in the eye
  - keep the empty capsular bag open for IOL insertion
  - support the anterior chamber and flatten the anterior capsule
  - dilate small pupils
  - dissect areas of adhesion

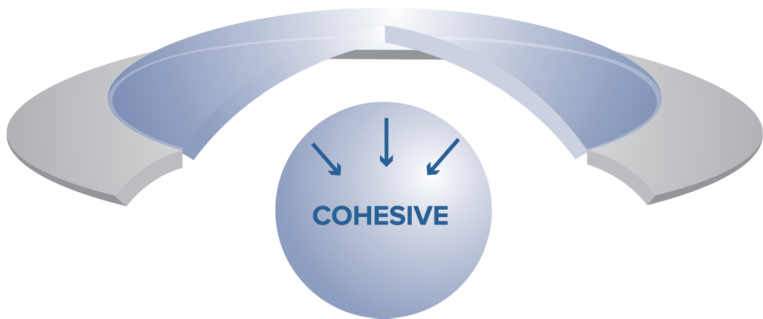

\*Not available in the US

Product design and/or features that do not influence its functionality and main parameters are subject to change.

# DISPOSABLE KNIVES

## HIGH PRECISION DISPOSABLE KNIVES WITH SAFETY SYSTEM

All knives are equipped with safety function lids

6  
PER  
BOX

PHACO  
PACK

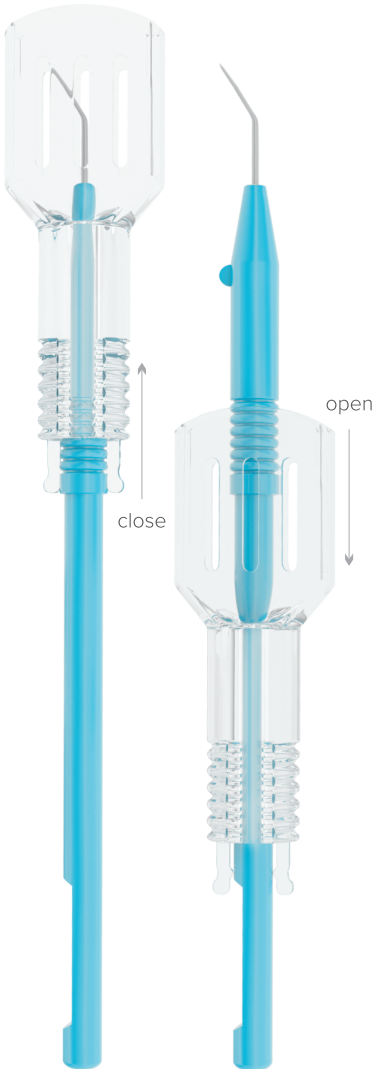

### CATARACT

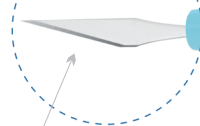

Exquisite sharpness for effortless penetration and withdrawal.

**MOST  
POPULAR**

#### Side Port Knives

initial stab incisions  
**double bevel, straight**  
SP-15 1.00 mm, 15°  
SP-30 1.00 mm, 30°  
SP-45 1.00 mm, 45°

### CATARACT

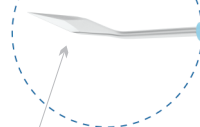

Angled option of paracentesis knife helps to avoid blocking the spot of intended incision.

#### Paracentesis Knives

paracentesis/side port incisions  
**double bevel, angled**  
PK-11 1.10mm

### CATARACT

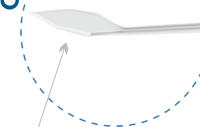

Absolutely smooth surface and anti-glare coating ensures the maximal Intraoperative comfort.

#### Trapezoidal Knives

tunnel incisions  
**single bevel, angled**  
TR-10 1.20-1.40 mm  
TR-17 1.50-1.70 mm

### CATARACT

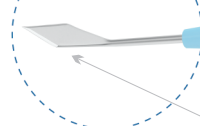

Optimal design of cutting edges allows for performance of watertight corneal incisions.

**MOST  
POPULAR**

#### Slit Knives

scleral tunnel incisions  
**single bevel, angled**  
SL-18 1.80 mm  
SL-22 2.20 mm  
SL-24 2.40 mm  
SL-26 2.65 mm  
SL-27 2.75 mm  
SL-28 2.80 mm  
SL-32 3.20 mm

PHACO  
PACK

# DISPOSABLE KNIVES

CATARACT

**MOST  
POPULAR**

PHACO  
PACK

## Clear Corneal Knives

clear cornea incisions  
**double bevel, angled**

CC-22	2.20 mm
CC-24	2.40 mm
CC-26	2.65 mm
CC-27	2.75 mm
CC-30	3.00 mm

Ultra-thin profile reduces penetration force and contributes to re-epithelialization.

**MOST  
POPULAR**

6  
PER  
BOX

CATARACT

## Clear Corneal Knives with Depth Indicators

tunnel incisions  
**double bevel, angled**

CCD-22	2.20 mm
CCD-24	2.40 mm
CCD-26	2.65 mm
CCD-27	2.75 mm

Depth indicators of 1.50, 1.75, 2.00 mm for controlled diving.

GLAUCOMA

**MOST  
POPULAR**

## Crescent Knives

lamellar dissections/flap formation

**single bevel, angled**

CR-20	2.00 mm
-------	---------

Facet-free blade for smooth flap formation.

**MOST  
POPULAR**

## MVR Knives

posterior segment penetration/  
side port incisions

**multifacet**

VRS-19	19 Ga, Straight
VRS-20	20 Ga, Straight
VRS-23	23 Ga, Straight
VRA-19	19 Ga, Angled
VRA-20	20 Ga, Angled
VRA-23	23 Ga, Angled

Promotes safe and easy sclerotomy for vitreoretinal procedures.

LRI

## Pre-Set Knives

groove making/limbal  
relaxing incisions

**multifacet**

PD-60	600µm Depth
-------	-------------

Pre-set style blade allows for fixed cutting depth of 600 microns and clear view of patient's cornea.

Other sizes are available upon request

Product design and/or features that do not influence its functionality and main parameters are subject to change.

# DISPOSABLE INSTRUMENTS FOR ANTERIOR SEGMENT

## SPECULUMS

### Barraquer Wire Speculum

14-022D

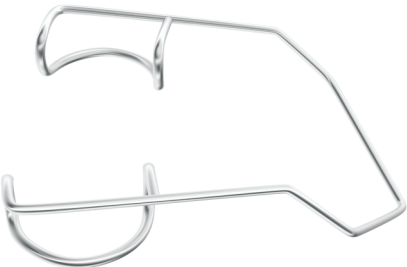

6  
PER  
BOX

PHACO  
PACK

## IRIS RETRACTORS

Safe and comfortable dilation and fixation of a rigid pupil.

### Iris Retractors

4  
PER  
BOX

10-5016-1

**MOST  
POPULAR**

5  
PER  
BOX

10-5067-1



## SCISSORS

Unique blade sharpening technology allows controlled cutting of various tissues with minimal pressure applied.



**Vannas  
Capsulotomy  
Scissors**  
Sharp Tips

11-052D



**Castroviejo  
Universal  
Corneal  
Scissors**  
Blunt Tips

11-012D

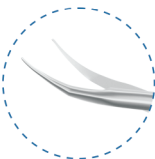

**Westcott  
Tenotomy  
Scissors**  
Blunt Tips

11-040D



# DISPOSABLE INSTRUMENTS FOR ANTERIOR SEGMENT

## FORCEPS

Perfectly aligned tips make every surgical manipulation safe and easy.

6  
PER  
BOX

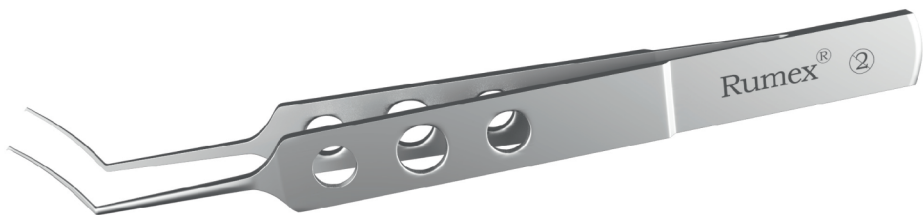

### Ultrata Capsulorhexis Forceps

Cystotome Tips  
Straight

4-0311D

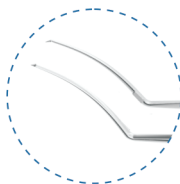

### Ultrata Capsulorhexis Forceps

Cystotome Tips  
Curved

4-0331D

PHACO  
PACK

**MOST  
POPULAR**



### Bonn-Catalano Corneal Forceps

0.12 mm, 1x2 Teeth  
Straight

4-0551D



### Castroviejo Suturing Forceps

0.12 mm, 1x2 teeth  
Straight

4-0600D

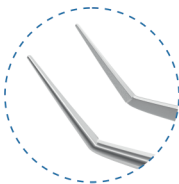

### McPherson Tying Forceps

Angled

4-174D



### McPherson Tying Forceps

Curved

4-177D

Product design and/or features that do not influence its functionality and main parameters are subject to change.

# DISPOSABLE INSTRUMENTS FOR ANTERIOR SEGMENT

## MANIPULATORS

Premium quality stainless steel ensures stiffness and flexibility of the working part.

6  
PCS  
BOX



**Spatula for Femtosecond**  
Laser Procedure

20-204D



**Nagahara Phaco Chopper**  
RHD

7-063D

PHACO  
PACK

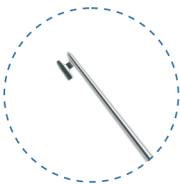

**Kuglen Iris Hook**  
Angled

5-030D



**Rosen Phaco Chopper**  
Universal

7-065D



**Sinskey Hook**  
Angled

5-032D

PHACO  
PACK



**Drysdale Nucleus Manipulator**  
Universal

7-093D

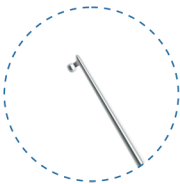

**Lester Lens Manipulator**  
Angled

5-0331D

# DISPOSABLE INSTRUMENTS FOR POSTERIOR SEGMENT

Entirely stainless instruments are manufactured as an integral tool with an intact inner spring mechanism that provides for precise performance and instant tactile control.

## FORCEPS\*

6  
PER  
BOX



### Eckardt End-Gripping Forceps

**12-410-23D** 23 Ga  
**12-410-25D** 25 Ga



### End-Grasping Forceps

**12-420-23D** 23 Ga  
**12-420-25D** 25 Ga



### Gripping Forceps With a "crocodile platform"

**12-304-23D** 23 Ga  
**12-304-25D** 25 Ga



### Gripping Forceps

**12-301-23D** 23 Ga  
**12-301-25D** 25 Ga



### Pick Forceps

**12-325-23D** 23 Ga  
**12-325-25D** 25 Ga

## SCISSORS\*

6  
PER  
BOX



### Curved Scissors

**12-209-23D** 23 Ga  
**12-209-25D** 25 Ga

\*Not available in the US

Product design and/or features that do not influence its functionality and main parameters are subject to change.

# SILICONE OIL

## SILICONE OIL

### SMARTSIL 1000/5000\* Purified Silicone Oil for Vitreoretinal Surgery

SmartSil 1000/5000 is used for prolonged tamponade after surgical treatment for severe retinal detachment.

- Maximum interfacial tension and minimum interactions between tissues, cells, and endo-tamponades media
- Optimal combination of specific gravity, refractive index and surface tension
- The choice of viscosity for a balance between easy injection and a stable temporary tamponade



**\*Not available in the US**

### Physico-chemical properties

Interfacial tension	≥ 40 mNm <sup>-1</sup> at 37°C
Density	0.97
Viscosity	1000/5000 cSt
Refractive index	1.40
Volatility	< 1%
Polydispersity	< 2.8
Volume of oil	10 ml
Syringe	20 ml
Shelf life	3 years

## SILICONE OIL INFUSION SYSTEMS

Surgical System	Disposable
Ioltech® Pentasys™, Optikon® Antares™, Alcon® STTO™, Storz® Premiere™, DORC®, Harmony Budget™	12-DTUB-1
DORC® Associate™, Alcon®, Constellation™, Accurus™	12-DTUB-2
B&L® Millenium™, Stellaris™	12-DTUB-3
Oerli® Orbit™, Faros™, OS3™	12-DTUB-4

### Viscous Fluid Injection Cannula

10 mm polyimide tip allowing injection of viscous fluids such as silicone oil through the 23Ga trocar cannula during the vitreoretinal surgery.

**12-5248** 23Ga X 10mm



# DISPOSABLE TROCAR SYSTEM

## One Step Trocar System

5  
PER  
BOX

Trocar System is an essential device in every vitreoretinal surgery. It is used as a port to gain access into the eye through which other surgical instruments can be introduced to aid in surgical procedures.

### Each package includes:

1. Trocar knife with preloaded trocar cannula – 3 pcs
2. Self-sealing trocar cannula (preloaded) – 3 pcs
3. Infusion line (for BSS) – 1 pcs
4. Trocar cannula inserter - 3 pcs

■ **12-5229** 23 Ga

■ **12-5244** 25 Ga

### Trocar knife

with preloaded cannulas



### Trocar Cannula Inserter

the proximal end of the plastic handle (opposite to the knife) can be used as a caliper and a scleral marker (two dimensions, 3.00 and 4.00 mm)



### Self-Sealing Trocar Cannula

self-sealing silicone valves eliminating need for plugs



### Universal Infusion Line

universal infusion line for BSS



# VITREORETINAL DISPOSABLE CANNULAS

## DUAL BORE CANNULA

Simultaneous infusion of PFC  
and aspiration of intraocular fluids  
**12-5203** 23 Ga

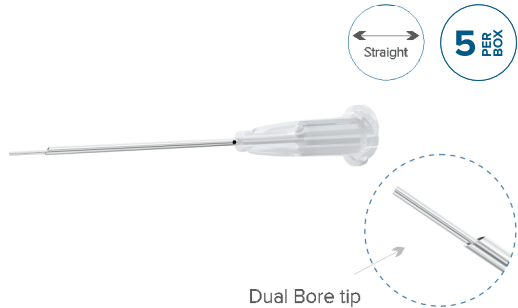

## CANNULAS FOR BACKFLUSH INSTRUMENTS

Used for retrograde flushing of incarcerated tissue during aspiration  
of intraocular fluids during vitreoretinal ophthalmic surgeries.

Allows for atraumatic  
aspiration of subretinal fluid

**12-5161** 23 Ga **← MOST POPULAR**  
**12-5152** 25 Ga

Soft tip

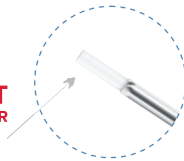

Ideal for atraumatic  
brushing of retina

**12-5162** 23 Ga  
**12-5160** 25 Ga

Brush tip

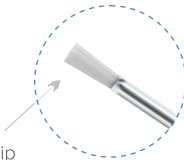

### Charles Flute Cannula

Designed for debris and blood  
aspiration from the posterior  
segment

**12-5164** 23 Ga

**MOST POPULAR**

Smooth blunt tip

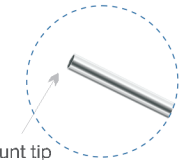

## DISPOSABLE BACKFLUSH HANDLES

Used with cannulas for Backflush Instruments.

### Backflush Handle

Passive Aspiration (hand-operated)  
**12-5197**



### Replacement Reservoir for Backflush Handle

Passive  
**12-5147**



Product design and/or features that do not influence its functionality and main parameters are subject to change.

# DISPOSABLE CANNULAS

## CANNULA TIPS BY PROCEDURE

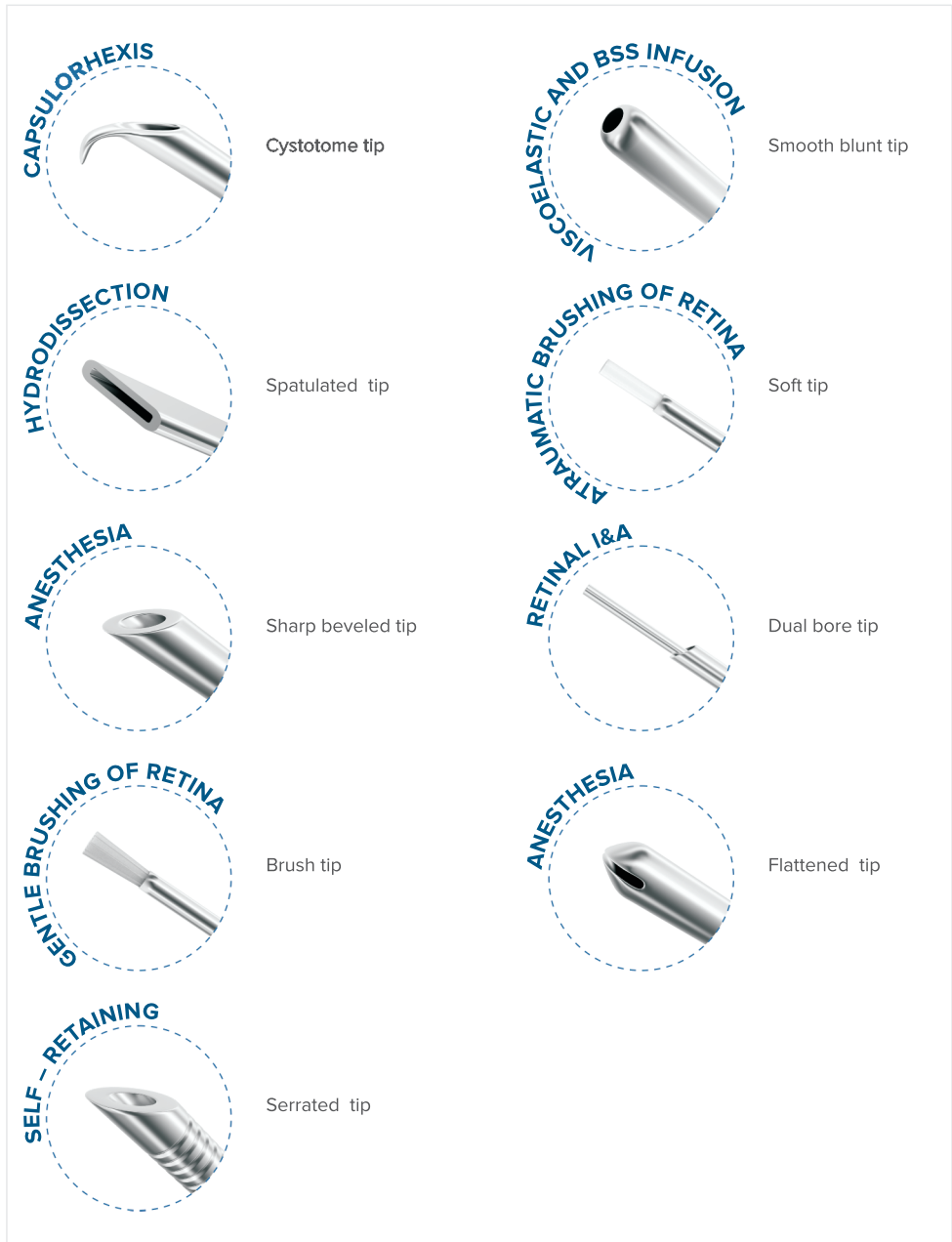

Product design and/or features that do not influence its functionality and main parameters are subject to change.

# DISPOSABLE CANNULAS

## ANTERIOR CHAMBER CANNULAS, RYCROFT

Used for maintaining and forming the anterior chamber by injecting or removing air, fluids, viscoelastics and intraocular medications.

**21-R2023** 23 Ga x 22 mm  
**21-R2025** 25 Ga x 22 mm

**21-R2030** 30 Ga x 22 mm  
**21-R2027-8** 27 Ga x 22 mm ← **MOST POPULAR**

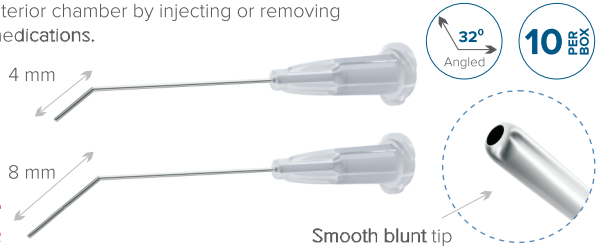

## ANTERIOR CHAMBER MAINTAINER, LEWICKY

Provides control over the depth of the anterior chamber during eye surgical procedures.

**21-R2520** 20 Ga x 22 mm

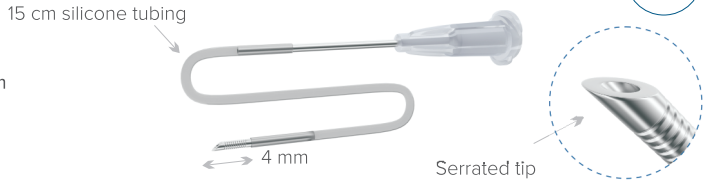

## VISCOELASTIC CANNULAS

Used for injecting viscoelastic to all meridians of the anterior chamber and to coat the intraocular lens.

**21-R2225** 25 Ga x 22 mm ← **MOST**  
**21-R2227** 27 Ga x 22 mm ← **POPULAR**

**21-R2323** 23 Ga x 22 mm  
**21-R2327** 27 Ga x 22 mm

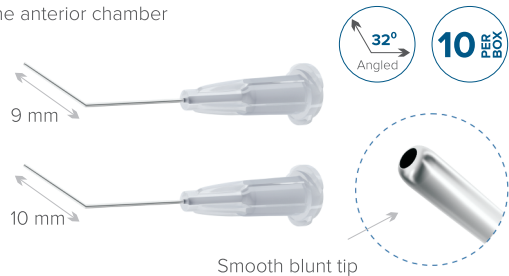

## IRRIGATING CYSTOTOMES, PEARCE

Provides an easier access to the anterior capsule during the capsulorhexis.

**21-R3027** 27 Ga x 16 mm  
**21-R3330** 30 Ga x 16 mm – for capsulotomy on deep-set eyes or small pupils

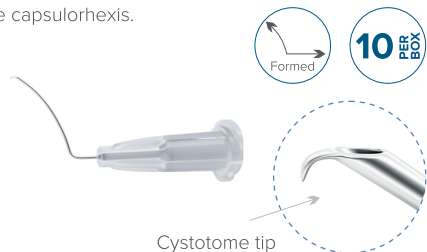

Product design and/or features that do not influence its functionality and main parameters are subject to change.



# DISPOSABLE CANNULAS

## HYDRODISSECTION CANNULAS

Used for easy placement under the anterior capsule to deliver fluids to facilitate the separation of the cortex from the nucleus and capsule.

**Hydrodissector, Pearce** **MOST POPULAR**  
**21-R4025** 25 Ga x 22mm



Spatulated tip



**Hydrodissector, Pearce** **MOST POPULAR**  
**21-R4027** 27 Ga x 22mm



**Hydrodissector**  
**21-R4427** 27 Ga x 22 mm



Smooth blunt tip

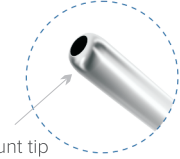

## CORTEX EXTRACTOR, SIMCOE

Used to remove the tissue especially at the difficult 12'oclock position with the top port for more effective aspiration.

**21-R5023** 23 Ga x 22 mm



Smooth blunt tip

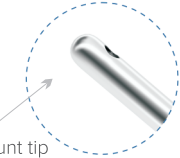

## CANNULAS FOR ANESTHESIA

**Retrobulbar Needle, Atkinson**  
For injecting anesthetic agents into the muscle cone.

**21-R1125** 25 Ga x 38 mm



Sharp beveled tip



**Sub-Tenon's Cannula**  
For administering anesthetic agents into the posterior Sub-Tenon's space.

**21-R1320** 20 Ga x 25 mm



Flattened tip

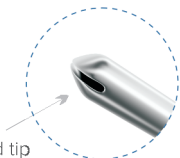

Product design and/or features that do not influence its functionality and main parameters are subject to change.

# DISPOSABLE CANNULAS

## LACRIMAL INTUBATION AND DACRYOCYSTORHINOSTOMY (DCR)

Designed for surgical treatment, repair and irrigation of the nasolacrimal system.

**Lacrimonal Intubation Set** **MOST POPULAR**  
**21-R7004** 27 Ga x 110 mm

**21-R7004RD** 27 Ga x 110 mm,  
 With Retrieval Device



**Lacrimonal Intubation Set** **MOST POPULAR**  
**21-R7001** 23 Ga x 175 mm

**21-R7011** 20 Ga x 45 mm



**DCR Set**  
**21-R7012** 20 Ga x 45 mm



**Lacrimonal Intubation Tubing** **MOST POPULAR**  
**21-R7002**



## LACRIMAL CANNULA

Used for probing and irrigating the lacrimal duct.

**21-R7021** 21 Ga x 33 mm  
**21-R7026** 26 Ga x 28 mm **MOST POPULAR**



## LASIK CANNULA, LINDSTROM

Used after ablation to wash away particulates from anterior and posterior sides of the flap and stromal bed.

3 ports  
**21-R7430** 25 Ga X 25.4 mm



Product design and/or features that do not influence its functionality and main parameters are subject to change.

# DISPOSABLE CANNULAS

Cannulas Gauge Conversion Chart

Gauge	Inner Diameter		Outer Diameter		Colour
	In	mm	In	mm	
19G	.028	.70	.043	1.10	
20G	.024	.60	.036	.90	
21G	.020	.51	.032	.80	
22G	.016	.41	.028	.70	
23G	.013	.33	.025	.60	
24G	.012	.30	.022	.55	
25G	.010	.25	.020	.50	
26G	.010	.25	.018	.45	
27G	.008	.20	.016	.40	
30G	.006	.15	.012	.30	

RUMEX International Company  
13770 58th Street North, Suite 303  
Clearwater, FL 33760  
USA

USA & Canada

☎ +1 (727) 535 9600

☎ +1 (877) 77 RUMEX (Toll-Free)

■ +1 (727) 535 8300

Europe, Asia, Africa, Latin America

☎ +371 6616 3182

✉ [rumex@rumex.com](mailto:rumex@rumex.com)

🌐 [rumex.net](http://rumex.net)

🏠 [www.rumex.com](http://www.rumex.com)





# **SINGLE-USE PRODUCTS**